

# KALLER®

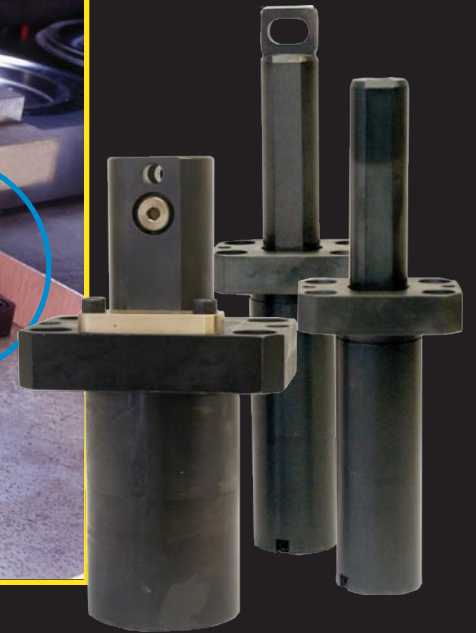

**New!**  
**SPC 800 for multi-point  
guide rail lifting**

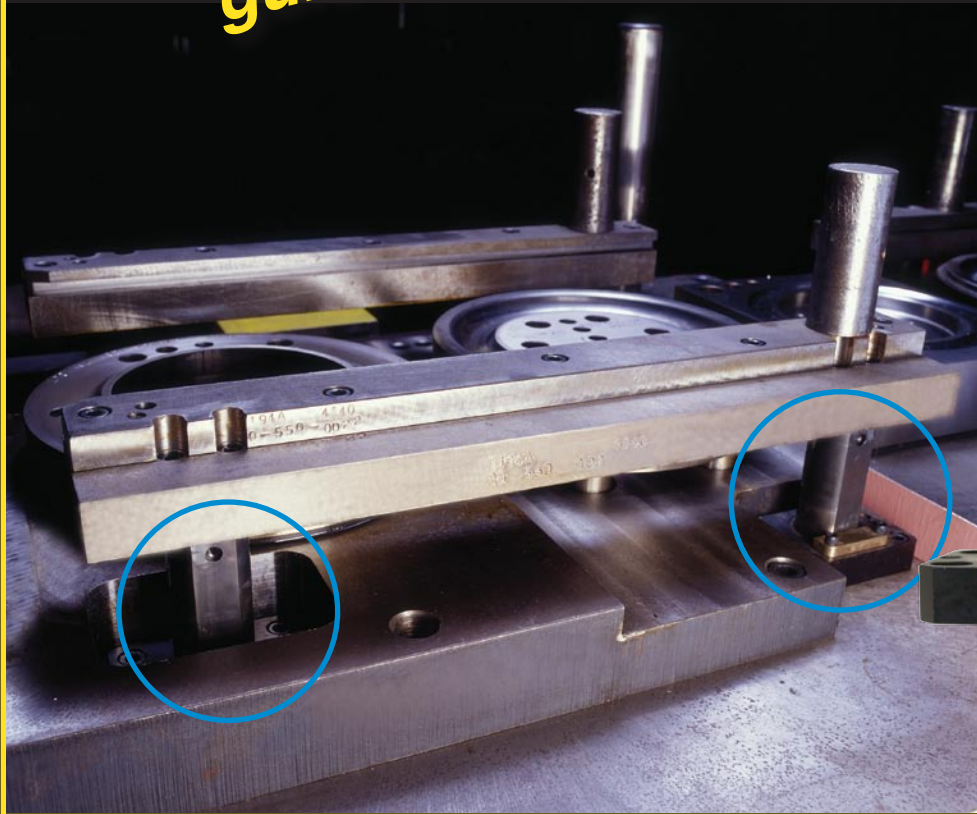

**Stock Lifters SLM 170, SLM 300 & SPC 800**

## SLM 170 & 300 and SPC 800 Stock Lifter Gas Springs

- Simplify tool design.
- Save cost and space.
- Eliminate need for additional guide bushings or anti-rotational feature.
- Easily adjustable force.
- Double tube design isolates gas spring from side load and fluid contamination.
- SLM 170 and SPC 800 can be hosed for uniform lifting force.
- SPC 800 dampens last 20 mm of return stroke speed to bring guide rail to a smooth stop.

SLMT 170

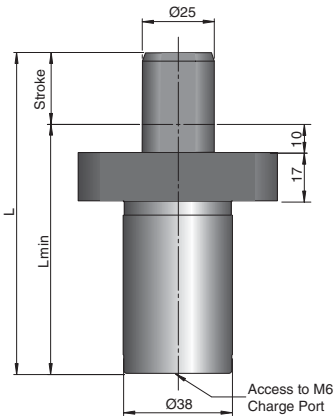

SLME 170

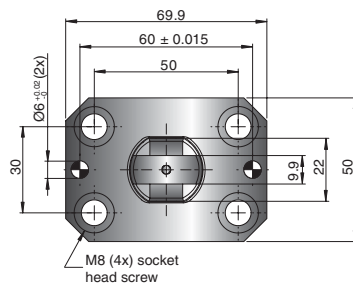
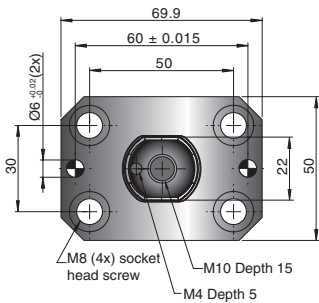
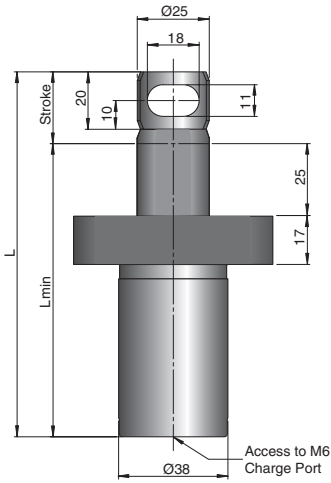

Millimeters to Inches: mm ÷ 25.4 = inches  
 Kilograms to Pounds: Kg ÷ 0.45 = pounds  
 Pounds Force to DecaNewtons: LbF x 0.4448 = decaNewtons

Order No.	Stroke S	Pounds Force (lbF) at 2610 psi		L	L min
		Initial	End Force*		
SLMT 170-025	25	380	630	112	87
SLMT 170-038	38			138	100
SLMT 170-050	50			162	112
SLMT 170-080	80			225	145
SLMT 170-100	100			265	165
SLMT 170-125	125			315	190
SLME 170-025	25	380	630	127	102
SLME 170-038	38			153	115
SLME 170-050	50			177	127
SLME 170-080	80			240	160
SLME 170-100	100			280	180
SLME 170-125	125			330	205

\* At full stroke

### Basic Information

#### SLMT/SLME 170

Initial force range .....240-1700 N/54-380 lbF  
 Pressure medium ..... Nitrogen  
 Charging pressure range ...25-180 bar/360-2610 psi  
 Operating temperature range .....0-80°C/0-176°F  
 Force increase by temperature .....±0.3%/°C  
 Recommended max strokes/min .... 40-100 (at 20°C)  
 Max. piston rod velocity ..... 1.6 m/sec  
 Max. utilized stroke .....100%  
 Internal gas spring..... X 170

### Mounting Examples

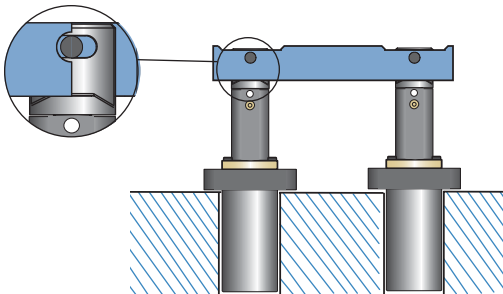

Note: Use ear attachment for multi-point lifting only.

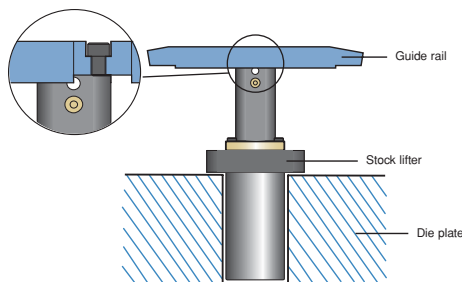

Note: Use threaded holes for single point lifting only.



## Dimensions

### SLM 300

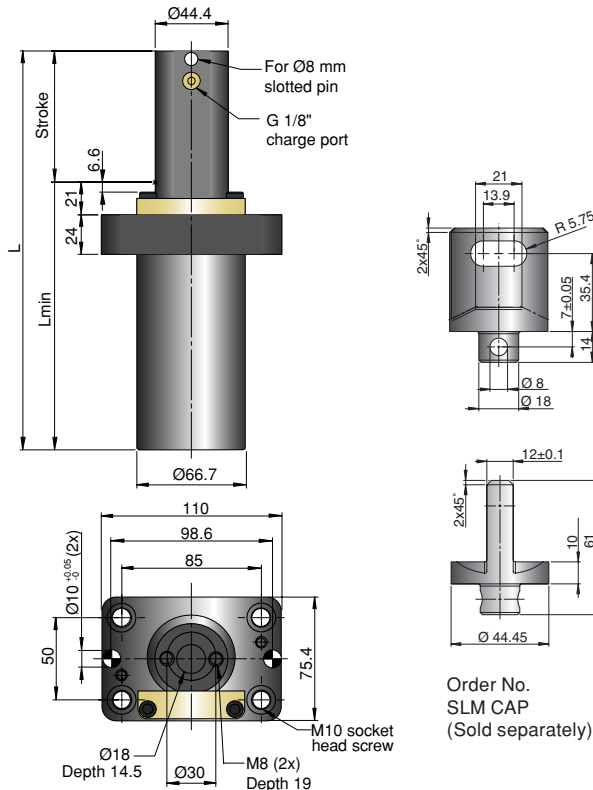

SLM CAP option to be mounted to top of SLM 300 and linked to guide rails of the die with a slotted pin.

Order No.	Stroke S	Pounds Force (lbF) at 2610 psi		L	L min
		Initial	End Force*		
SLM 300-025	25	720	967	146	121
SLM 300-050	50		967	196	146
SLM 300-080	80		978	256	176
SLM 300-100	100		978	296	196
SLM 300-125	125		978	349	221
SLM 300-150	150		978	396	246
SLM 300-163	163		978	422	214
SLM 300-175	175		978	446	226
SLM 300-200	200		978	496	251
SLM 300-210	210		978	516	261

\*At full stroke

### SPC 800

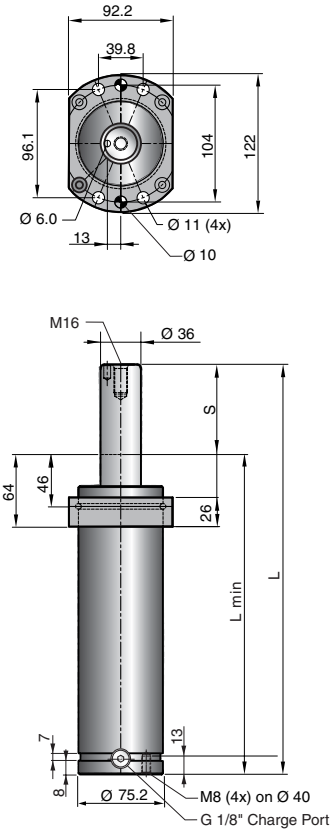

Order No.	Stroke S	Pounds Force (lbF) at 1015 psi		L	L min
		Initial	End Force**		
SPC 800-050	50	1600	1980	304	254
SPC 800-080	80		2070	364	284
SPC 800-100	100		2115	404	304
SPC 800-125	125		2160	454	329
SPC 800-150	150		2185	504	354
SPC 800-175	175		2205	554	379
SPC 800-200	200		2230	604	404

\*\* At full stroke

## Basic Information

### SLM 300

Initial force range .....890-3200 N/200-720 lbF  
 Pressure medium ..... Nitrogen  
 Charging pressure range ..... 25-180 bar  
 /360-2610 psi  
 Operating temperature range .....0-80°C/0-176°F  
 Force increase by temperature ..... ±0.3%/°C  
 Recommended max strokes/min ..... 10-100 (at 20°C)  
 Max. piston rod velocity ..... 1.6 m/sec  
 Max. utilized stroke .....100%  
 Repair kit .....3020870

### SPC 800

Initial force range ..... 1525-7100 N/345-1600 lbF  
 Pressure medium ..... Nitrogen  
 Charging pressure range ..... 15-70 bar/220-1015 psi  
 Operating temperature range .....0-80°C/0-176°F  
 Force increase by temperature .....±0.3%/°C  
 Recommended max. strokes/min ..... ~25 (at 20°C)\*  
 Max. utilized stroke .....100%  
 Dampening length .....~20 mm  
 Dampening speed ..... 0.2 m/s  
 Repair kit ..... 3021492

\*By halving the initial charge pressure, the number of strokes per minute can be doubled.



# KALLER®

## The Safer Choice

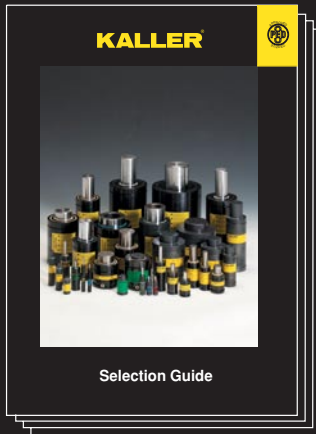

### Gas Springs

Kaller developed the first nitrogen gas spring for press tools and today offers a comprehensive selection of high quality gas springs for use in different tool & die applications.



### Controllable Gas Springs-KF2

Kaller controllable springs are a family of gas springs, for use in press tools, that can be locked in their bottom position and where the return stroke of the spring can be controlled.

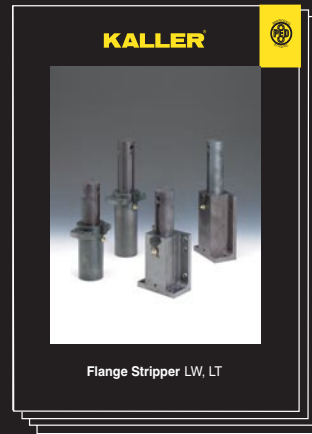

### Flange Stripper Unit

Kaller Flange Stripper Unit is used in flanging dies for stripping/lifting a flanged part after forming. It provides 200 daN of stripping force, can be top or bottom mounted and is self guiding.

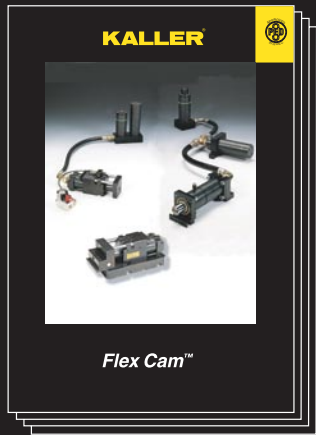

### Flex Cam™

The Flex Cam is used for piercing, cutting, forming and flanging operations. The system allows for a flexible distribution of forces with optimal direction and velocity. By using a Flex Cam, fewer tools are required in production.



### Roller Cam

Kaller Roller Cam is used for piercing, trimming, flanging and restriking. The Roller Cam can be mounted in both vertical and horizontal angles.

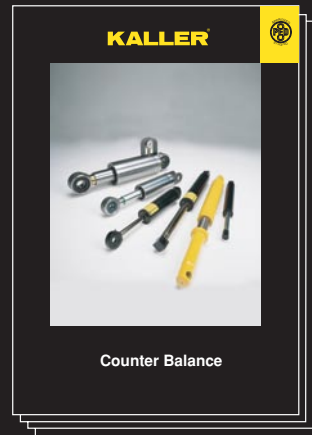

### Counter Balance

Kaller Counter Balance gas springs can be used to lift, lower, assist, balance, and hold in a multitude of applications.



33280 Groesbeck Highway  
Fraser, MI 48026 USA  
Phone: 1-888-200-7190  
586-415-6677  
Fax: 586-415-6699



For more information see our website  
[www.kaller.com](http://www.kaller.com)

©2007 Kaller  
June 2007